

Notes
 1. Air photography obtained from Bluesky International Ltd taken on 27th June 2010.
 2. Plots and their location are traced from the photo and are estimated only, these must be verified by ground inspection.
 3. Plots are numbered with an integer for the front plot (e.g. 170) adding a suffix of "A" for the rear plot (e.g. 170A). Where plots are let combined the A suffix is dropped.

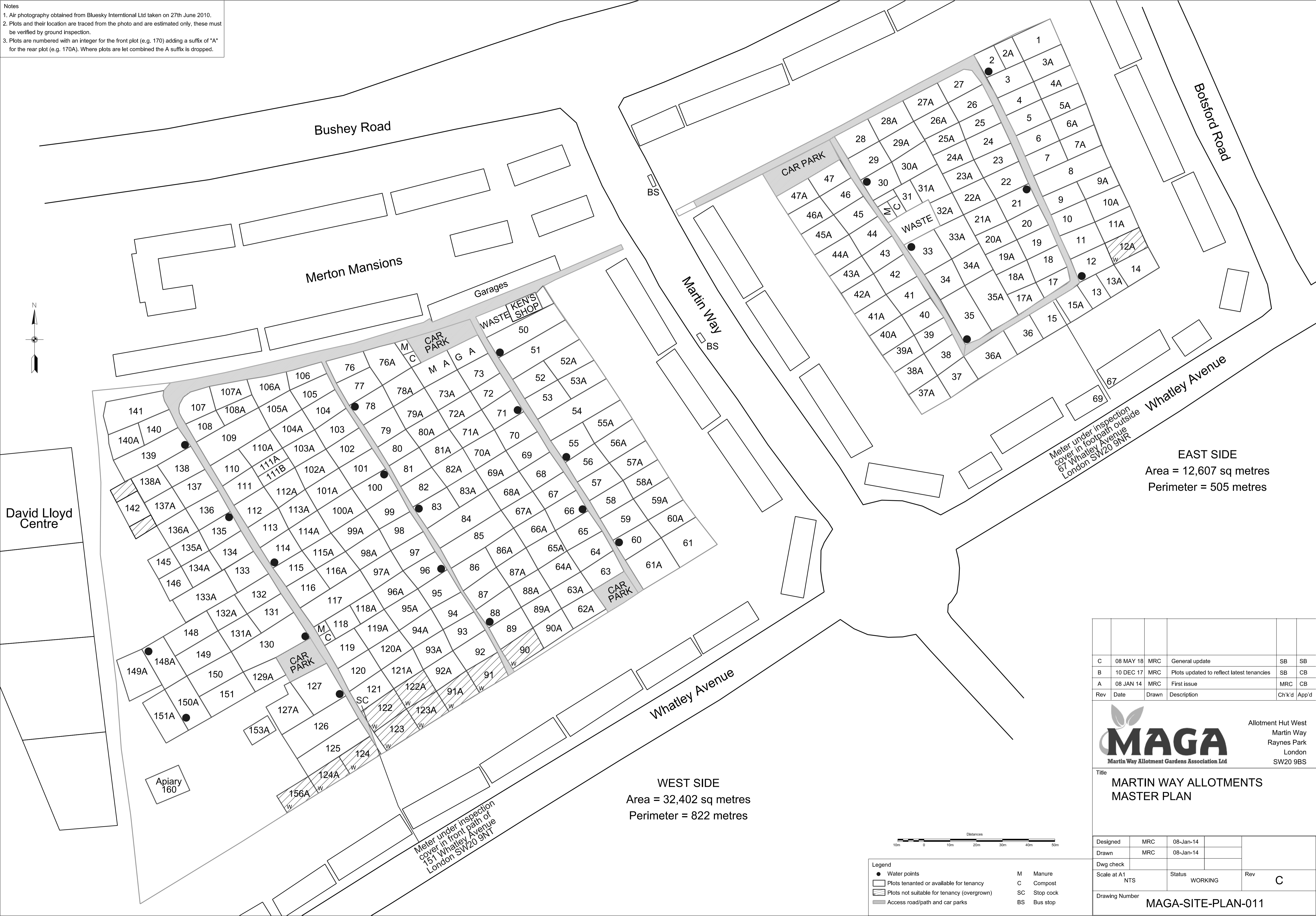

EAST SIDE
 Area = 12,607 sq metres
 Perimeter = 505 metres

WEST SIDE
 Area = 32,402 sq metres
 Perimeter = 822 metres

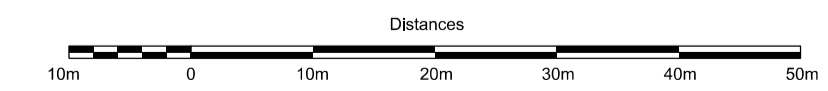

Legend

● Water points	M Manure
□ Plots tenanted or available for tenancy	C Compost
▨ Plots not suitable for tenancy (overgrown)	SC Stop cock
▬ Access road/path and car parks	BS Bus stop

C	08 MAY 18	MRC	General update	SB	SB
B	10 DEC 17	MRC	Plots updated to reflect latest tenancies	SB	CB
A	08 JAN 14	MRC	First issue	MRC	CB
Rev	Date	Drawn	Description	Ch'k'd	App'd

MAGA
 Martin Way Allotment Gardens Association Ltd

Allotment Hut West
 Martin Way
 Raynes Park
 London
 SW20 9BS

Title
**MARTIN WAY ALLOTMENTS
 MASTER PLAN**

Designed	MRC	08-Jan-14	
Drawn	MRC	08-Jan-14	
Dwg check			
Scale at A1	NTS	Status	WORKING
Rev			C

Drawing Number
MAGA-SITE-PLAN-011